

# CupboardsEXpress<sup>®</sup>



## HIGH QUALITY



## AFFORDABLE PRICES



## FULL CUSTOMIZATION

### Edmonton North

Showroom & Manufacturing  
EdmontonNorth@CupboardsExpress.com EdmontonSouth@CupboardsExpress.com  
13030 - 146 Street,  
Edmonton, AB  
780.413.2260

### Edmonton South

Showroom  
4607 - 99 Street,  
Edmonton, AB  
780.432.2511

### Red Deer

Showroom  
RedDeer@CupboardsExpress.com  
101, 6660 Taylor Drive,  
Red Deer, AB  
403.986.6464

### Calgary North

Showroom & Warehouse  
CalgaryNorth@CupboardsExpress.com  
Bay C, 2020 - 32 Avenue,  
Calgary, AB  
587.353.9904

### Calgary South

Showroom  
CalgarySouth@CupboardsExpress.com  
1307 - 11501 Buffalo Run Blvd  
Tsuut'ina, AB  
587.775.4650

# Proudly Alberta Made Since 1958

# MAPLE DOORS

Maple cabinets have a fine, indistinct grain making it a popular choice for contemporary designs. This hard, light coloured wood is finished to a fine luster. Although generally understated, maple develops a sophisticated character when treated with dark, penetrating stains.

*Colours may vary slightly depending on your viewing device*

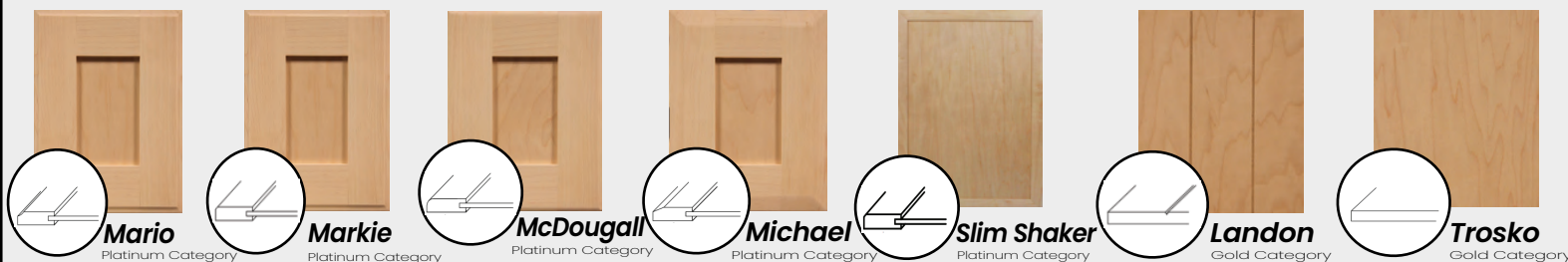

# OAK DOORS

Oak is a favourite for its strength, stability and consistency. Stains accentuate its distinctive grain for a timeless look and unmatched durability.



# STAIN OPTIONS



# Earth Series





# HICKORY DOORS

With its rich colour variation and distinguished dark lines, hickory provides a unique look. It takes stains consistently and is exceptionally strong and durable.

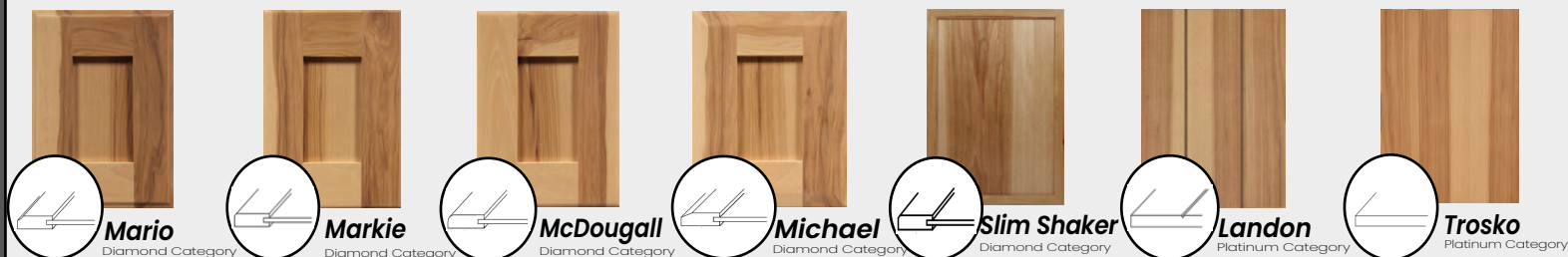

## STAIN OPTIONS

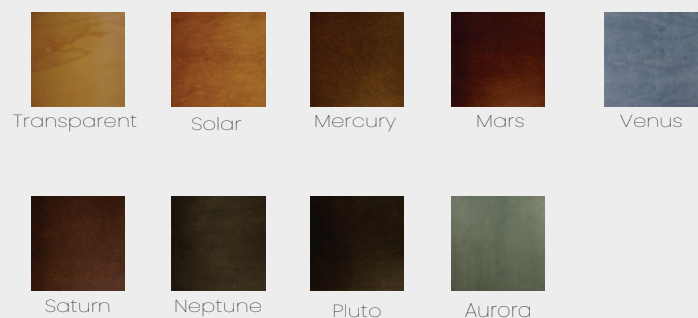

## Earth Series



# CHERRY DOORS

Adding value to any home, cherry is often considered the king of cabinet woods. Taking all finishes well, its variable and unique grain pattern provides an air of refined luxury.

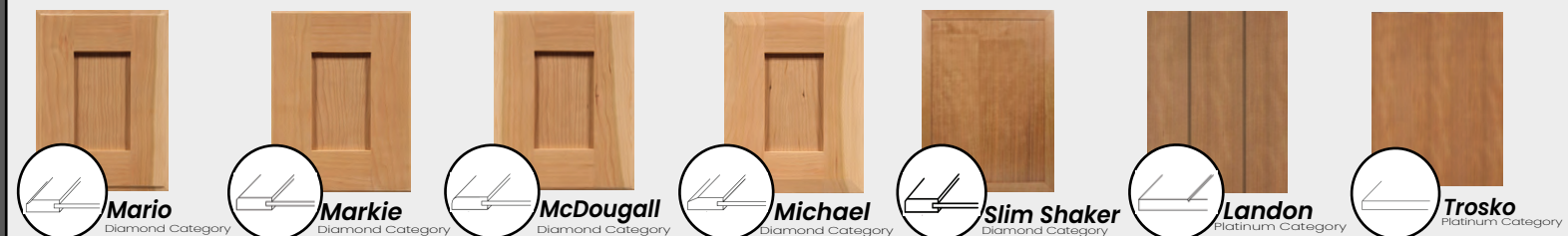

## STAIN OPTIONS

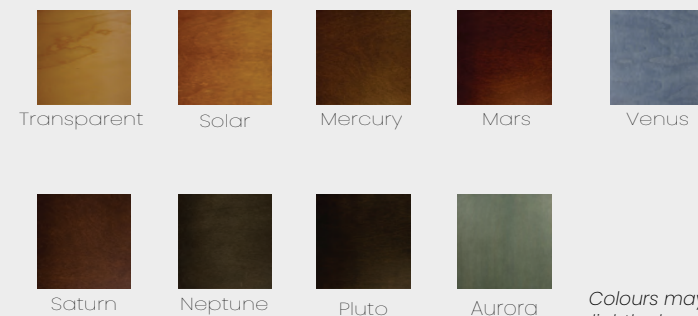

Colours may vary slightly depending on your viewing device



# MDF DOORS

We use the highest quality Medium Density Fiberboard (MDF) available. MDF is a high grade composite material made from recycled wood. Its unmatched dimensional stability makes it the best choice for painted surfaces.



## COLOURS



White



Cream



Antique White



Grey White



Grey

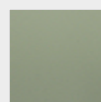

Willow



\*Custom

Colours may vary slightly depending on your viewing device

# POLYMER DOORS

Polymer surfaces provide the most durable and scratch resistant gloss finish. Superior to vinyl by a wide margin, polymer doors are the perfect choice for a clean, modern look.

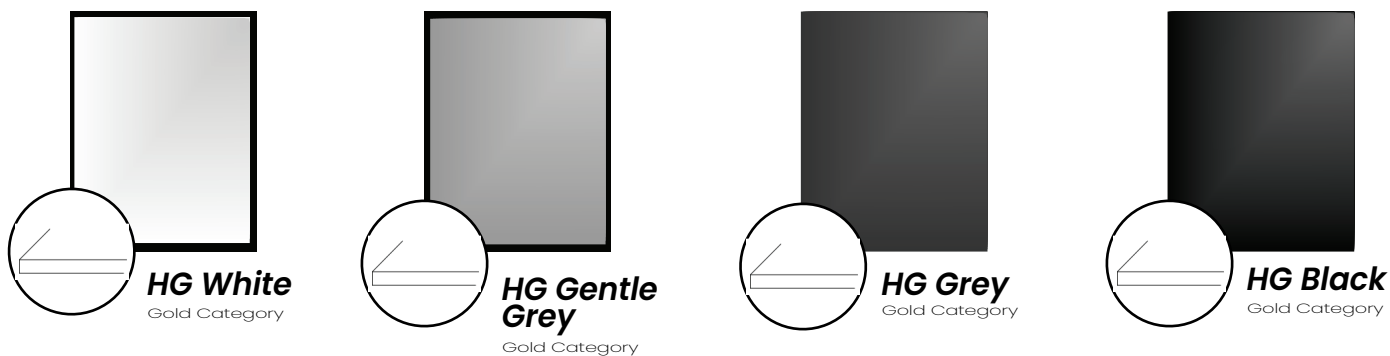

Colours may vary slightly depending on your viewing device

# NEXTEK SHAKER DOORS

GOLD CATEGORY

Nextek doors feature a new polymer laminate material that is superior to all known cabinet finishes. It is more affordable, consistent and durable than wood or vinyl, and highly resistant to heat, chemicals and scratching.



**Black Rio**



**Cannes**



**Cassis**



**Chill**

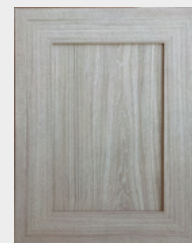

**Driftwood**



**Esterel**



**Haze**

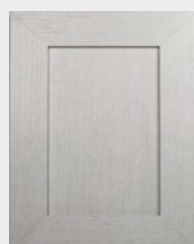

**Latitude North**

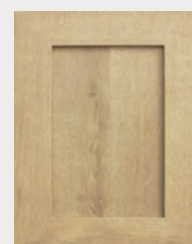

**Mistral**

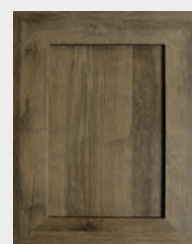

**Monaco**



**Nizza**



**Silva**



**Skye**



**Storm**



**White Rio**

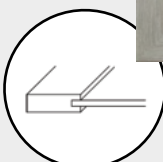

Edge Profile

# NEXTEK CHAMFER DOORS

GOLD CATEGORY  
Plus Special Setup



**Cassis**

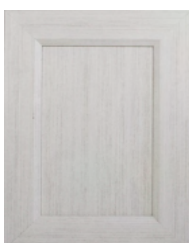

**Chill**



**Driftwood**



**Haze**



**Nizza**



**Skye**

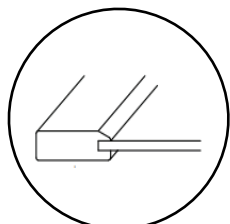

Edge Profile



# TFL DOORS

Superior to vinyl, Thermally Fused Laminate is a composite material of exceptional hardness. Inexpensive, durable and beautiful laminate doors come in a wide variety of colours, textures, and edge treatments.



**Navin - Colour Match**

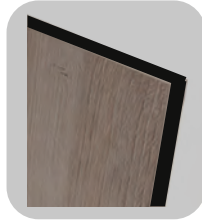

**Karen - 2mm Black**



**Karen - 2mm White**

## GOLD CATEGORY



**Black Rio**



**Cannes**



**Cassis**



**Chill**



**Driftwood**



**Esteral**



**Haze**



**Latitude North**



**Mistral**



**Monaco**



**Nizza**



**Silva**



**Skye**



**Storm**



**White Rio**

## BRONZE CATEGORY



**Antique White**



**Del Maple**

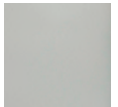

**Custom Grey**



**White**

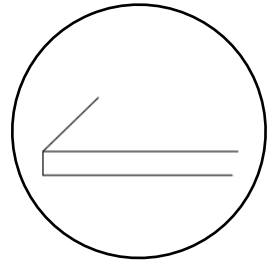

**Edge Profile**

# VELOUR TOUCH DOORS

## GOLD CATEGORY

Featuring a smooth, shine-free finish, these doors are also manufactured in Alberta and provide that matte finish that adds class to any room. This is the latest in design choices and is easy to clean.



**Bamboo Shoots**



**Cashmere Dusk**



**Cotton Mist\***



**Jersey Fog\***



**Oxford Grey**



**Suede Stone**



**Velour Black**

\*Available in Chamfer profile.  
Requires special setup.



# GLASS DOORS

In keeping with our theme of customization, add a touch of elegance and class - with glass! Available in two thicknesses and a variety of styles to choose from. Each style is also available in tempered glass.

## REGULAR GLASS



***Pinhead***



***3mm Clear***



***Rain***

## SPECIAL GLASS

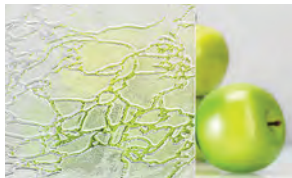

***Delta Frost***



***Glue Chip***



***Grey Tint***



***Krinkle***

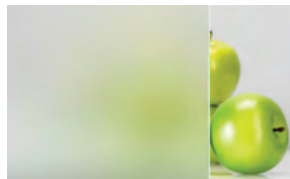

***Satin Etch***

# DOOR HANDLES

Complete your cabinetry's new look with our large variety of handles. The extensive selection will leave you with plenty of options for your perfect space. Stocking handles are ready and on site.

## STOCKING



BP10734900  
(Matte Black)



BP8041195  
(Brushed Nickel)



33205195  
(Brushed Nickel)



BP82196195  
(Brushed Nickel)



BP9161196195  
(Brushed Nickel)



BP65017900  
(Matte Black)



16338195  
(Brushed Nickel)



BP820128195  
(Brushed Nickel)



650020128195  
(Brushed Nickel)



650020128900  
(Matte Black)



BP805128195  
(Brushed Nickel)



305128195  
(Brushed Nickel)



BP650128195  
(Brushed Nickel)



BP821128195  
(Brushed Nickel)



BP814332900  
(Matte Black)



BP260637BORB  
(Brushed Oil - Rubbed Bronze)



82905128195  
(Brushed Nickel)



BP5016128195  
(Brushed Nickel)



BP5016128BORB  
(Brushed Oil - Rubbed Bronze)



BP2606128195  
(Brushed Nickel)



BP2606128BORB  
(Brushed Oil - Rubbed Bronze)



BP2606128143  
(Antique Nickel)



51278128195  
(Brushed Nickel)



56206128195  
(Brushed Nickel)



BP82871128195  
(Brushed Nickel)



BP82871128158  
(Brushed Aulum Gold)



BP82871128140  
(Chrome)



BP82871128900  
(Matte Black)



BP810128143  
(Antique Nickel)



BP811128195  
(Brushed Nickel)



BP8160128195  
(Brushed Nickel)



BP8160128900  
(Matte Black)



BP8160128160  
(Brushed Aulum Gold)



BP7340128195  
(Brushed Nickel)



BP7340128900  
(Matte Black)



## TOP ("T") CABINET - ONE DOOR

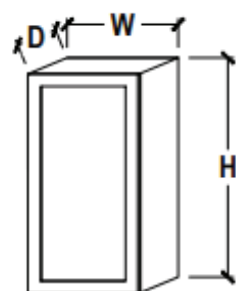

### STANDARD SIZES

(CUSTOM SIZES AVAILABLE UPON REQUEST)

WIDTHS	HEIGHTS
9"W	13"H
12"W	30"H
15"W	36"H
18"W	39"H
21"W	42"H

CABINET CODE e.g., T1530

\* STANDARD TOP CABINET BOX IS 11 7/8"D

## TOP ("T") CABINET - TWO DOORS

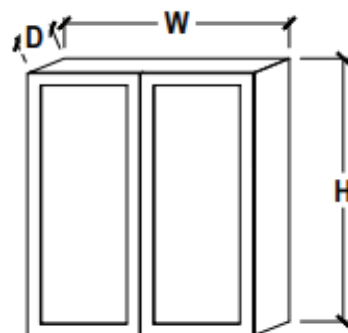

### STANDARD SIZES

(CUSTOM SIZES AVAILABLE UPON REQUEST)

WIDTHS	HEIGHTS
24"W	13"H
27"W	30"H
30"W	36"H
33"W	39"H
36"W	42"H
39"W	

CABINET CODE e.g., T3036

\* STANDARD TOP CABINET BOX IS 11 7/8"D

## TOP ("T-ED") CABINET - EXTRA DEEP

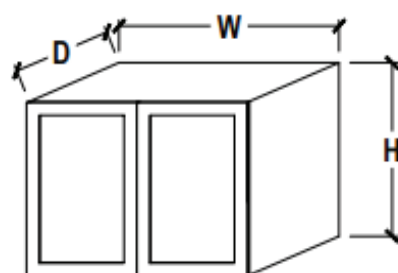

### STANDARD SIZES

(CUSTOM SIZES AVAILABLE UPON REQUEST)

WIDTHS	HEIGHTS
30"W	13"H
33"W	19"H
36"W	22"H
39"W	25"H

CABINET CODE e.g., T3319ED

\*STANDARD EXTRA DEEP TOP CABINET BOX IS 23 1/2"D

## TOP ("TA") CABINET - ANGLED CORNER

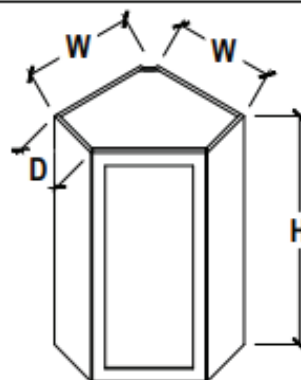

### STANDARD SIZES

(CUSTOM SIZES AVAILABLE UPON REQUEST)

WIDTHS	HEIGHTS
21"W	30"H
24"W	36"H
	39"H
	42"H

CABINET CODE e.g., TA2436

\* STANDARD TOP ANGLED CABINET BOX IS 11 7/8"D

## COUNTERTOP ("CT") CABINET - TWO DOORS

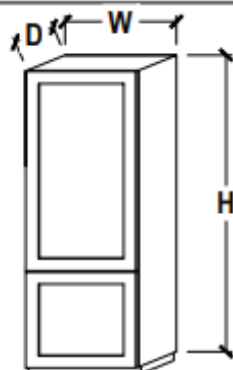

### STANDARD SIZES

(CUSTOM SIZES AVAILABLE UPON REQUEST)

WIDTHS	HEIGHTS
12"W	48"H
15"W	54"H
18"W	57"H
21"W	60"H

CABINET CODE e.g., CT1854

\*STANDARD COUNTERTOP CABINET BOX IS 11 7/8"D

## COUNTERTOP ("CT") CABINET - FOUR DOORS

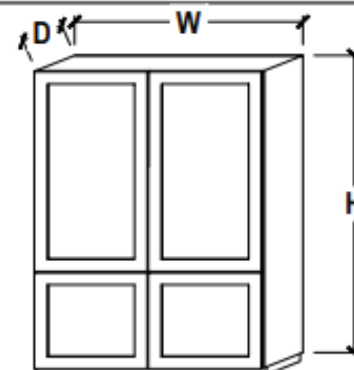

### STANDARD SIZES

(CUSTOM SIZES AVAILABLE UPON REQUEST)

WIDTHS	HEIGHTS
24"W	48"H
27"W	54"H
30"W	57"H
33"W	60"H
36"W	

CABINET CODE e.g., CT3660

\*STANDARD COUNTERTOP CABINET BOX IS 11 7/8"D

## BASE BANK OF 2 DRAWERS ("B2D") CABINET

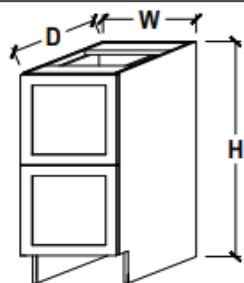

### STANDARD SIZES

(CUSTOM SIZES AVAILABLE UPON REQUEST)

#### WIDTHS

12"W	27"W
15"W	30"W
18"W	33"W
21"W	36"W
24"W	39"W

CABINET CODE e.g., B2D27

\*STANDARD BASE CABINET BOX IS 34 3/4"H X 23 1/2"D

## BASE BANK OF 3 DRAWERS ("B3D") CABINET

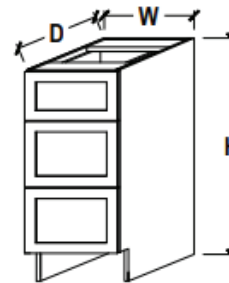

### STANDARD SIZES

(CUSTOM SIZES AVAILABLE UPON REQUEST)

#### WIDTHS

12"W	27"W
15"W	30"W
18"W	33"W
21"W	36"W
24"W	39"W

CABINET CODE e.g., B3D24

\*STANDARD BASE CABINET BOX IS 34 3/4"H X 23 1/2"D

## BASE BANK OF 4 DRAWERS ("B4D") CABINET

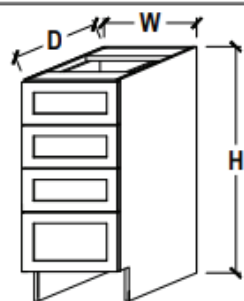

### STANDARD SIZES

(CUSTOM SIZES AVAILABLE UPON REQUEST)

#### WIDTHS

12"W	27"W
15"W	30"W
18"W	33"W
21"W	36"W
24"W	39"W

CABINET CODE e.g., B4D24

\*STANDARD BASE CABINET BOX IS 34 3/4"H X 23 1/2"D

## BASE ("BK") CABINET - 90° CORNER BI-FOLD

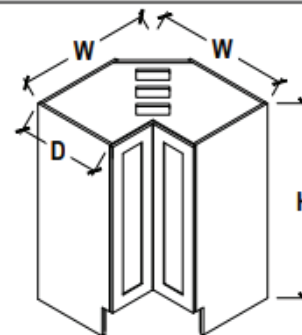

### STANDARD SIZES

(CUSTOM SIZES AVAILABLE UPON REQUEST)

#### WIDTHS

33" X 33"W
36" X 36"W
39" X 39"W

CABINET CODE e.g., BK3636

\*STANDARD BASE CABINET BOX IS 34 3/4"H X 23 1/2"D

## BASE ("BC") CABINET - BLIND CORNER

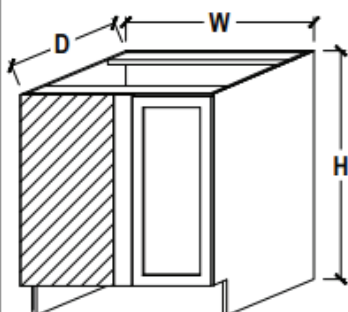

### STANDARD SIZES

(CUSTOM SIZES AVAILABLE UPON REQUEST)

#### WIDTHS

36"W
39"W
42"W

AVAILABLE IN LEFT & RIGHT VERSIONS

CABINET CODE e.g., BC39

\*STANDARD BASE CABINET BOX IS 34 3/4"H X 23 1/2"D

## BASE ("BA") CABINET - ANGLED CORNER

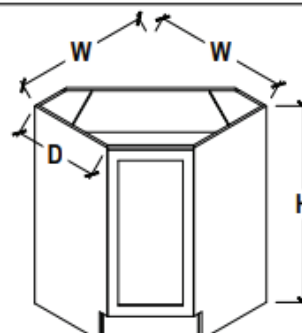

### STANDARD SIZES

(CUSTOM SIZES AVAILABLE UPON REQUEST)

#### WIDTHS

39"W - ONE DOOR
42"W - TWO DOORS

CABINET CODE e.g., BA39

\*STANDARD BASE CABINET BOX IS 34 3/4"H X 23 1/2"D

## BASE ("BASP") CABINET - ANGLED CORNER w/ SINK PANEL

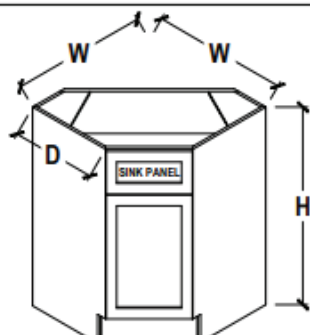

### STANDARD SIZES

(CUSTOM SIZES AVAILABLE UPON REQUEST)

#### WIDTHS

39"W - ONE DOOR
42"W - TWO DOORS

CABINET CODE e.g., BASP39

\*STANDARD BASE CABINET BOX IS 34 3/4"H X 23 1/2"D

## BASE ("BAE") CABINET - ANGLED END

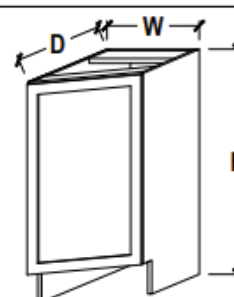

### STANDARD SIZES

(CUSTOM SIZES AVAILABLE UPON REQUEST)

#### WIDTHS

12"W
15"W

AVAILABLE IN LEFT & RIGHT VERSIONS

CABINET CODE e.g., BAE15

\*STANDARD BASE CABINET BOX IS 34 3/4"H X 23 1/2"D

## VANITY ("VD") CABINET - ONE DOOR & DRAWER

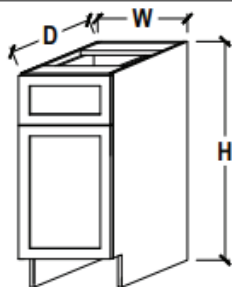

### STANDARD SIZES

(CUSTOM SIZES AVAILABLE UPON REQUEST)

#### WIDTHS

9"W  
12"W  
15"W  
18"W  
21"W

CABINET CODE e.g., VD15

\*STANDARD VANITY CABINET BOX IS 31 1/8"H X 20 1/2"D

## VANITY ("VD") CABINET - TWO DOORS & ONE DRAWER

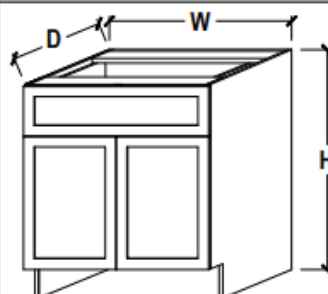

### STANDARD SIZES

(CUSTOM SIZES AVAILABLE UPON REQUEST)

#### WIDTHS

24"W

CABINET CODE e.g., VD24

\*STANDARD VANITY CABINET BOX IS 31 1/8"H X 20 1/2"D

## VANITY BANK OF 3 DRAWERS ("V3D") CABINET

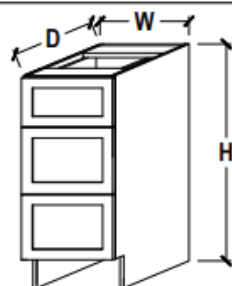

### STANDARD SIZES

(CUSTOM SIZES AVAILABLE UPON REQUEST)

#### WIDTHS

12"W  
15"W  
18"W  
21"W  
24"W

CABINET CODE e.g., V3D24

\*STANDARD VANITY CABINET BOX IS 31 1/8"H X 20 1/2"D

## VANITY SINK ("VSP") CABINET - ONE DOOR

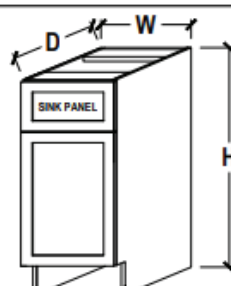

### STANDARD SIZES

(CUSTOM SIZES AVAILABLE UPON REQUEST)

#### WIDTHS

18"W  
21"W

CABINET CODE e.g., VSP21

MAPLE RAIL ADDED FOR SINK SUPPORT

\*STANDARD VANITY CABINET BOX IS 31 1/8"H X 20 1/2"D

## VANITY SINK ("VSP") CABINET - TWO DOORS

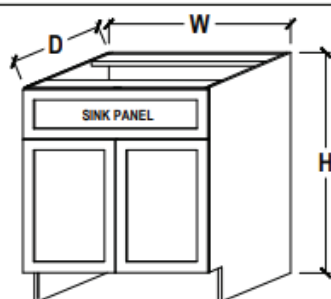

### STANDARD SIZES

(CUSTOM SIZES AVAILABLE UPON REQUEST)

#### WIDTHS

24"W  
27"W  
30"W  
33"W  
36"W  
39"W

MAPLE RAIL ADDED FOR SINK SUPPORT

CABINET CODE e.g., VSP36

\*STANDARD BASE CABINET BOX IS 31 1/8"H X 20 1/2"D

## VANITY SINK ("VSD") CABINET - ONE DOOR & TWO DRAWERS

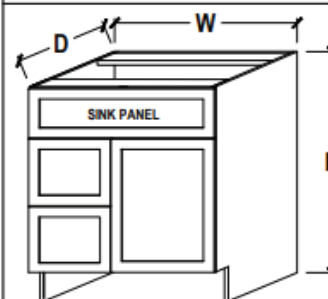

### STANDARD SIZES

(CUSTOM SIZES AVAILABLE UPON REQUEST)

#### WIDTHS

30"W  
33"W

CABINET CODE e.g., VSD30

AVAILABLE IN LEFT & RIGHT VERSIONS

MAPLE RAIL ADDED FOR SINK SUPPORT

\*STANDARD BASE CABINET BOX IS 31 1/8"H X 20 1/2"D

## VANITY SINK ("VSD") CABINET - TWO DOORS & DRAWERS

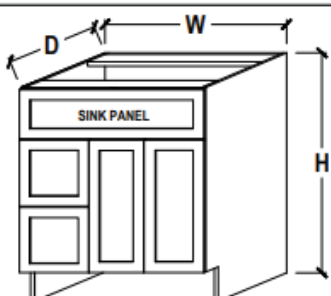

### STANDARD SIZES

(CUSTOM SIZES AVAILABLE UPON REQUEST)

#### WIDTHS

36"W  
39"W

CABINET CODE e.g., VSD36

AVAILABLE IN LEFT & RIGHT VERSIONS

MAPLE RAIL ADDED FOR SINK SUPPORT

\*STANDARD BASE CABINET BOX IS 31 1/8"H X 20 1/2"D

## VANITY SKIRT ("VDSKIRT") CABINET - ONE DRAWER

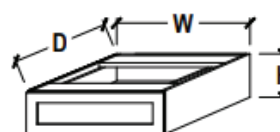

### STANDARD SIZES

(CUSTOM SIZES AVAILABLE UPON REQUEST)

#### WIDTHS

24"W  
27"W  
30"W  
33"W  
36"W

TYPICALLY USED FOR A MAKEUP VANITY OR DESK

CABINET CODE e.g., VDSKIRT30

\*STANDARD VANITY SKIRT BOX IS 7 1/4"H X 20 1/2"D



# CLOSETS

## WARDROBE TOP ("WT") CABINET

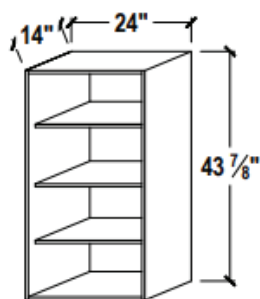

ONE STANDARD SIZE  
24"W X 43 7/8"H X 14"D

CUSTOM SIZES AVAILABLE  
UPON REQUEST - EXTRA  
DESIGN CONSIDERATIONS  
REQUIRED

FULLY FINISHED ALL  
AROUND

CABINET CODE e.g., WT24

## WARDROBE BASE ("WB") CABINET

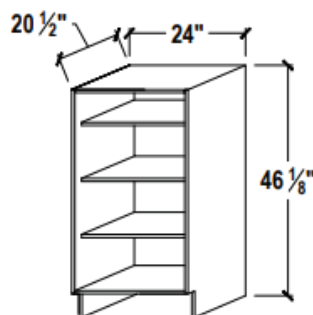

ONE STANDARD SIZE  
24"W X 46 1/8"H X 20 1/2"D

CUSTOM SIZES AVAILABLE  
UPON REQUEST - EXTRA  
DESIGN CONSIDERATIONS  
REQUIRED

FULLY FINISHED ALL  
AROUND

CABINET CODE e.g., WB24

## WARDROBE BANK OF DRAWERS ("WB4D") CABINET

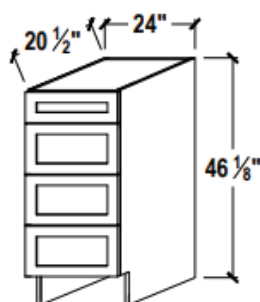

ONE STANDARD SIZE  
24"W X 46 1/8"H X 20 1/2"D

CUSTOM SIZES AVAILABLE  
UPON REQUEST - EXTRA  
DESIGN CONSIDERATIONS  
REQUIRED

FULLY FINISHED ALL  
AROUND INCLUDING  
DRAWER BOXES

CABINET CODE e.g., WB4D24

## CLOSET OPTIONS

**ROD** - HEAVY DUTY CLOSET ROD AVAILABLE IN  
LENGTHS OF 3, 4, 6, 8, & 12 FEET

**FLANGE** - CIRCULAR SUPPORTS FOR ROD TO SIT  
IN - INSTALLED ON FILLS ATTACHED TO WALL

**MID SUPPORTS** - BRACKETS TO SUPPORT THE  
MIDDLE OF RODS AND SHELVES

**CLOSET SHELF** - 15" DEEP SHELF TYPICALLY  
INSTALLED OVER A CLOSET ROD

**SHOE SHELF** - ANGLED SHOE SHELF TYPICALLY  
INSTALLED IN THE WARDROBE TOP CABINET

**SHOE ROLLOUT SHELF** - TYPICALLY  
INSTALLED IN THE WARDROBE BASE CABINET

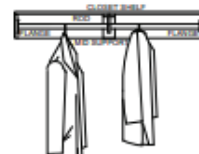

# BENCHES

## SEAT ("S") CABINET - ONE DOOR

**STANDARD SIZES**  
(CUSTOM SIZES AVAILABLE UPON REQUEST)

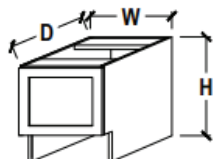

**WIDTHS**  
15"W  
18"W

CABINET CODE e.g., S15

\*STANDARD SEAT CABINET BOX IS 17 3/4"H X 20 1/2"D

## SEAT ("SD") CABINET - ONE DRAWER

**STANDARD SIZES**  
(CUSTOM SIZES AVAILABLE UPON REQUEST)

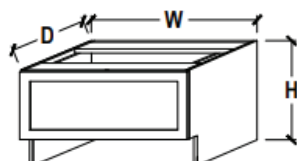

**WIDTHS**  
15"W  
18"W  
24"W  
30"W  
36"W

CABINET CODE e.g., SD24

\*STANDARD SEAT CABINET BOX IS 17 3/4"H X 20 1/2"D

## SEAT ("S") CABINET - TWO DOOR

**STANDARD SIZES**  
(CUSTOM SIZES AVAILABLE UPON REQUEST)

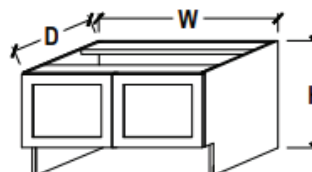

**WIDTHS**  
24"W  
30"W  
36"W

CABINET CODE e.g., S30

\*STANDARD SEAT CABINET BOX IS 17 3/4"H X 20 1/2"D

We offer a variety of cabinet modification options and accessories to give a custom feel without the custom prices! See in store for details.